

Pit Bull™ Series 147.5

To handle single 3/4" I.D. hose

Features

- 3/4" Female NPT Threads
- Pressures to 310 bar/4500 psi
- Temperatures from -40°C to +121°C
- Full flow hub
- Stainless steel fasteners
- Stainless steel hose guide
- Standard full flow 90° swivel inlet/outlet

Used For

- Fuel delivery*
- Air / water
- Waste oil evacuation**
- Bulk transfer grease
- Coolant



Model Number	Hose Capacity m		Approx. Weight kg		Hose Guide	Reel Dimensions*** mm												
	I.D. in. mm	3/4 19	NET	Freight SHIP Wt.		A	B	C	D	E	F AIR	F HYD	G	H	X1	Y1	X2	Y2
	O.D. in. mm	1-9/32 33																
PB20-220-650TGS		21	58	63	Single	319	216	290	300	690	420	610	690	375	213	250	183	200
PB20-220-650TGD		21	69	47	Dual	319	216	290	300	690	420	610	690	375	213	250	183	200
PB20-270-650TGS		26	59	64	Single	362	253	290	300	690	430	620	690	375	256	250	226	200
PB20-270-650TGD		26	69	74	Dual	362	253	290	300	690	430	620	690	375	256	250	226	200
PB20-290-650TGD		31	72	77	Dual	377	290	290	300	690	439	629	690	375	271	250	241	200

Notes

1. Specifications subject to change without notice.
2. Other sizes, from standard components, available upon request.
3. Weights shown in table are for air rewind models. ADD (kgs): Hydraulic & Electric 1.4 kg
4. Specify if evacuation/suction application prior
5. When ordering, prefix model number with:
A = Air E = Electric H = Hydraulic
6. Be sure to check dimensions and weights prior to ordering.

Air motor must have filtered / lubricated air supply. Install reel in attitude to prevent water penetration of air motor exhausts.

Flexible Connectors must be fitted between supply line to hose reel inlet swivel joint.

**Specify if evacuation suction application prior

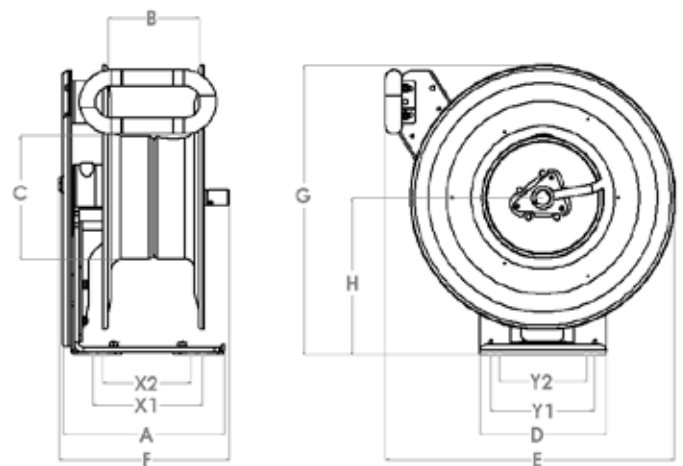

*** w, x, y and z indicate mounting holes

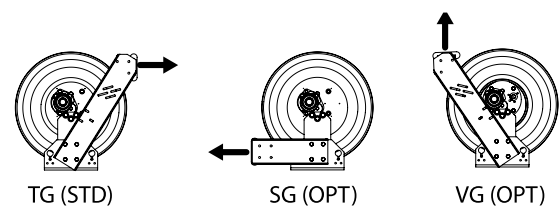

Available Hose Guide Positions

Ordering Example:

Hydraulic rewind reel to handle 34 metres of 3/4" I.D. Hose with TG single guide arm order as follows: **HPB20-220-650 TGS-4.5K**